

Notes from the Journey Home

Notes from the Journey Home



Les Deux Mondes, theatre company
7285 Chabot Street, Montréal, Québec CANADA H2E 2K7
Phone: +1 (514) 593-4417 ext. 245 / Fax: +1 (514) 593-6329
lesdeuxmondes.com

Preliminary Technical Rider

Technical Director: Rock Samson
Mobile: (514) 862-1696 roco83@videotron.ca

Revised August 27, 2009

Notes from the Journey Home - Ground plan (top view)

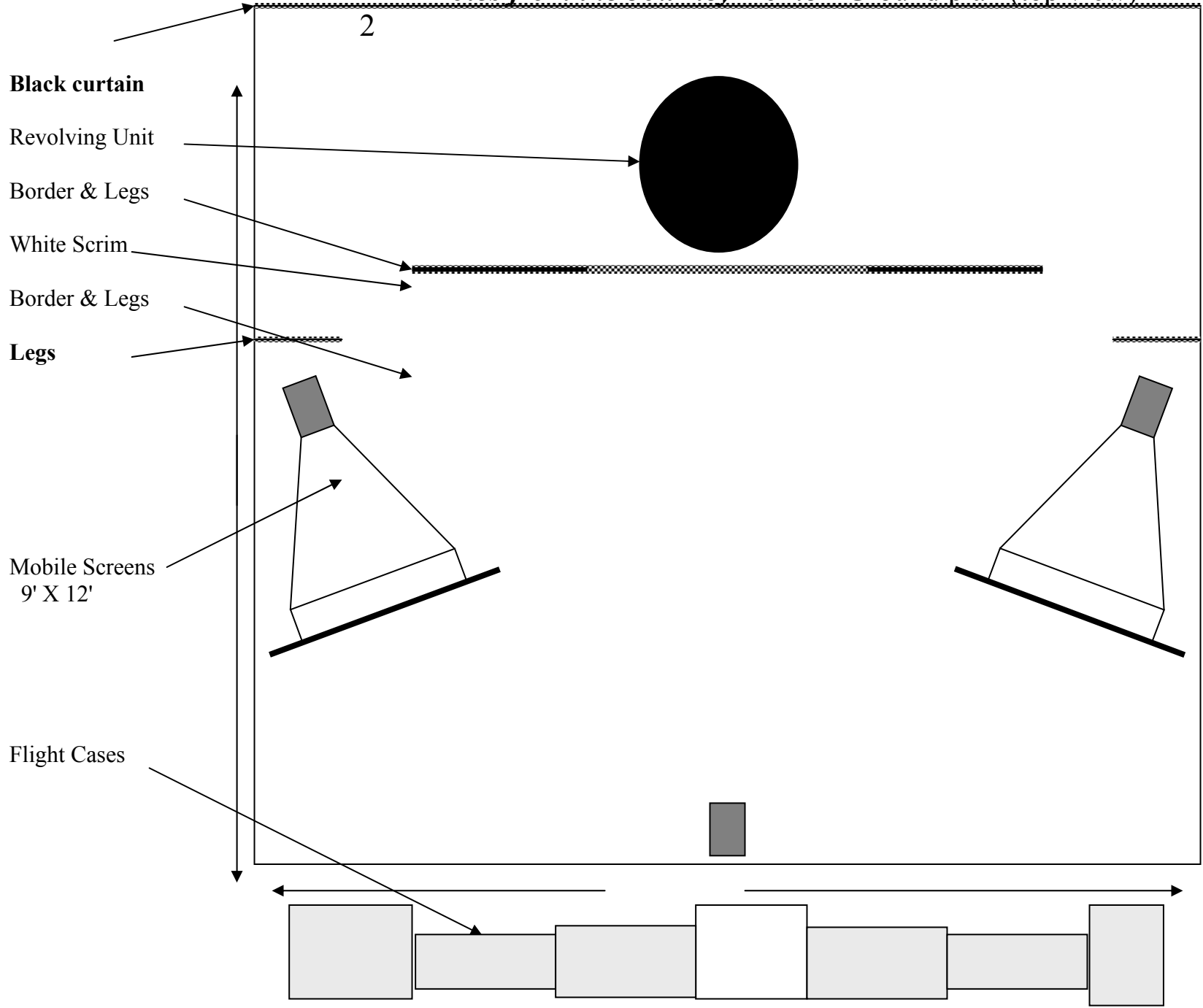

Performance length: 70 minutes; no intermission

Stage Requirements:

- Stage width: 9.14 metres (30 feet) or more
- *Note: Wings are not a requirement. The required stage width corresponds to the view the audience must have of the playing area.*
- Stage depth: 9.14 metres (30 feet) or more
- Height under grid: 4.90 metres (16 feet) or more
- Several flight cases will be installed between the first row and the foot of the stage. The first row in the audience will be required for the performers.

Though the show was created to allow the possibility of playing in smaller venues, it can also be performed in medium and large houses. To ensure the feasibility of our play in your theatre and since many of our technical elements are modifiable, we ask that your house and stage plans be studied by our technical director.

Set-up: Two 4 hour calls (1 day) **depending on the theatre and including a light pre-hang.**

Take-down: 2 to 4 hours

Required crew for both set-up and take-down:

1 head electrician + 3 electricians

1 head sound

1 video technician

1 head carpenter + 2 carpenters

In a fly-house: 1 head fly man + 1 assistant fly man

Please view the proposed schedule (attached).

Stage Equipment Requirements:

Sound:

- Three (3) range sound system (hi, mid, low)
- Two (2) stage monitors
- Two (2) monitors in the audience (surround sound)
- Cluster (in large houses only)
- Sufficient cabling for all equipment
- 50 AMP single phase power (we travel with our transformer)

Note:

- As the musician/sound operator performs throughout the representation, he must operate from the house with an unobstructed view of the stage in a 2.50 metre (8 feet) X 1.50 metre (5 feet) area.

Lighting:

- Please see proposed lighting plan and instrument list (attached).

FOH:	Leko 15/32	_____	18
Stage:	Leko 19°	_____	7
	Leko 26°	_____	8
	Leko 36°	_____	32
	Frenels 1K	_____	12
	Par 64 Med	_____	2
	Scoop	_____	2

Notes:

- We travel with our own board (DMX 512 protocol).
- The lighting operator can be in the booth.

Video:

- We supply all necessary video equipment.

Note:

- Our video technician can operate in the booth as long as he has a good view of the stage. The booth must easily have room enough to fit a 0.80 metre (30 inches) X 2.50 metre (8 feet) table and the operator. If the fore mentioned requirements cannot be met, the necessary space will have to be reserved in the house.

Stage:

- Black velour back curtain
- 3 sets of black velour legs and 2 borders
- Blue lighting for backstage
- 2 small props tables [0.50 metre (18 inches) X 0.50 metre (18 inches)]

Note:

- The stage floor must be black.
- The stage floor must be level (0° rake).

Dressing Rooms:

- Two (2) dressing rooms for four (4) people with mirrors, toilet, shower and sink
- Water, juice, coffee, tea and herbal tea...
- Cookies, cheese, fruit and nut platters...
- Washing machine and clothes dryer

Touring Staff : 8 or 9 people

- Director: Daniel Meilleur
- Musician: Michel Robidoux
- Multimedia: Yves Dubé
- Lighting: Martin Lepage
- Stage Managers: Rock Samson and Marcello Ponce
- Performers: Véronique Marchand and Jean-François Casabonne
- Development and Tour Director (on occasion)

Annexe

1- Proposed Schedule (with pre-hang):

8.00	Arrival of the technical crew / Meet and greet
8.15	Unloading of the truck / Start of set-up
10.00	Break
10.15	Continue set-up
12.00	Lunch for all (sound adjustments)
13.00	Lighting and video focus (lunch for sound)
15.00	Break
15.15	Continue set-up
17.00	End of set-up / Dinner for all
18.00	Show call
18.30	Sound check and stage positions with performers
19.30	Audience entrance
20.00	Performance
21.15	Strike
24.00	Departure / Thank-you

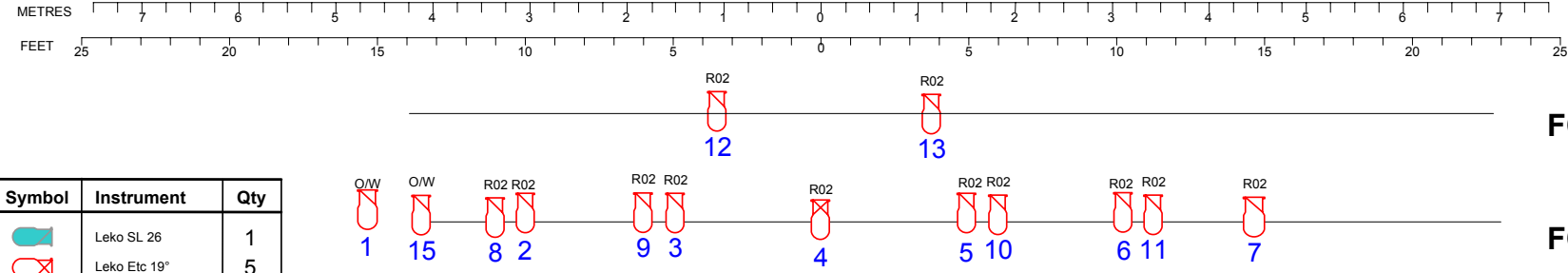
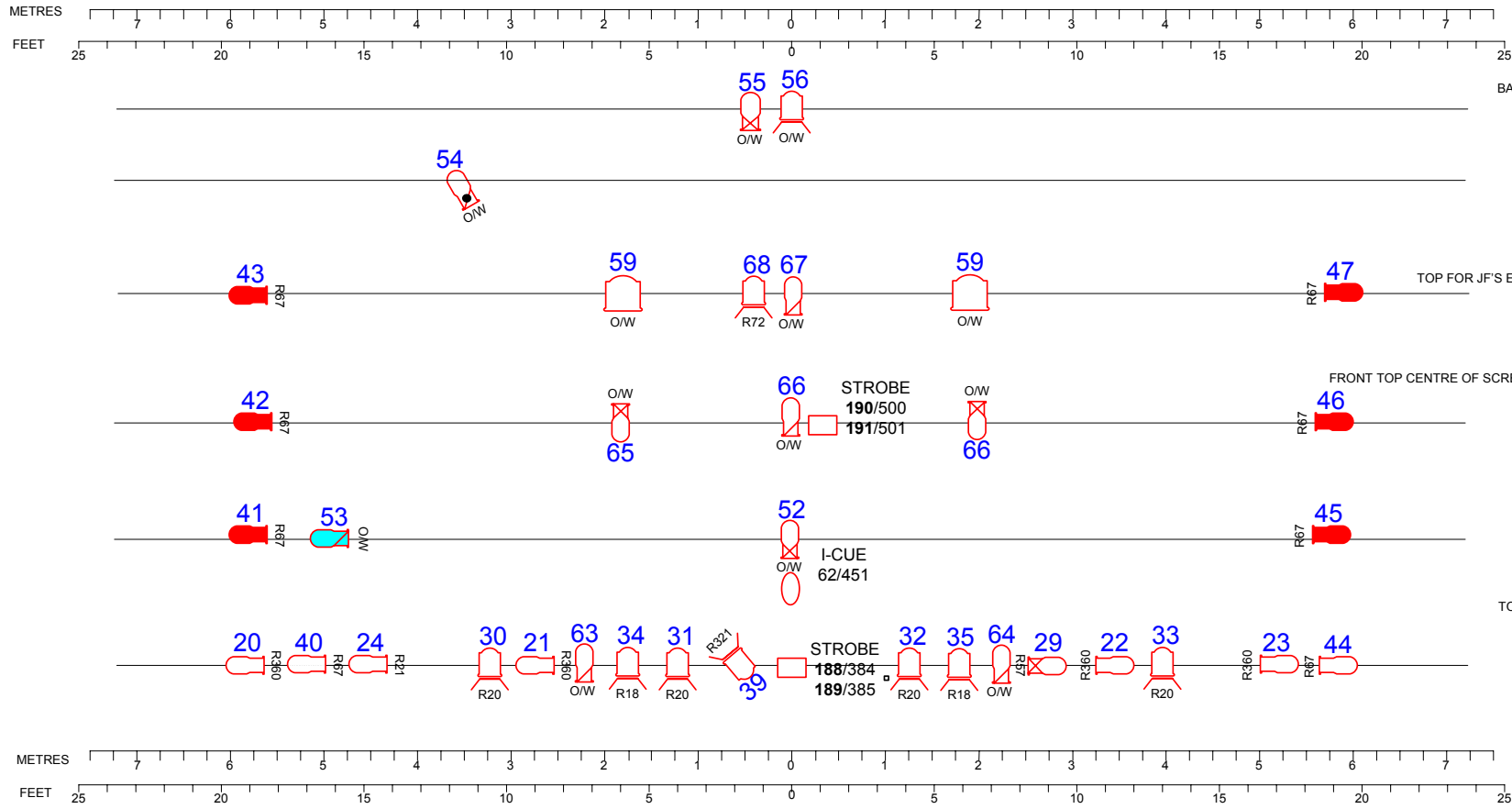

Symbol	Instrument	Qty
	Leko SL 26	1
	Leko Etc 19°	5
	Leko Etc 26°	15
	Leko Etc 36°	9
	Leko Shakespeare	6
	Fresnel 750w	10
	Scoop	2

with gobo

Les Deux Mondes travel with their lighting console.

Please see booms on page 2.

LX plot version 2, NOTES FROM THE JOURNEY HOME	
DEUX MONDES, March 2009 rehearsals	
LX PLOT	
Director: Daniel Meilleur	Page 1 of 2
Designer: Martin Lepage	Scale 3/16" = 1'
Drawing: Martin Lepage	March 15, 2009

Stage Right

Boom 5 SR
upstage/scrim

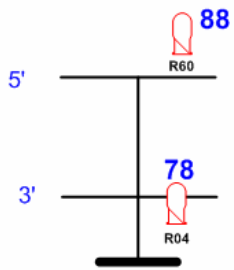

104
circ
pastille



Stage Left

Boom 5 SL
upstage/scrim

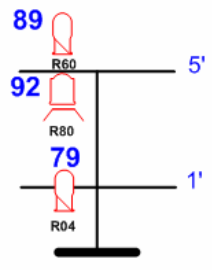

Boom 4 SR

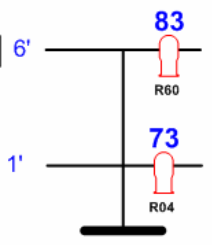

Boom 4 SL

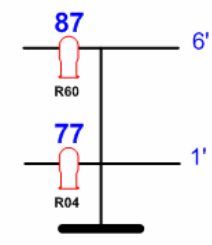

Boom 3 SR

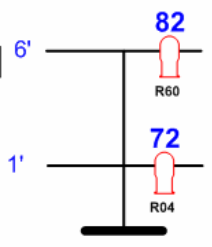

Boom 3 SL

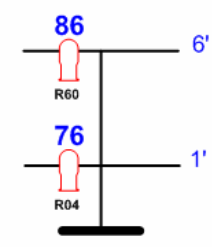

Boom 2 SR

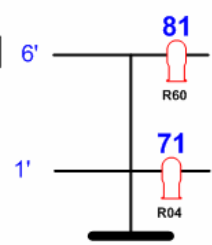

Boom 2 SL

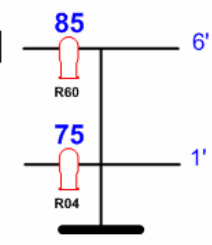

101
sent

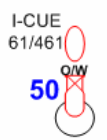

I-CUE
61/471

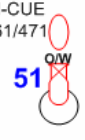

Boom 1 SR
downstage

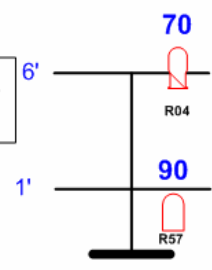

Boom 1 SL
downstage

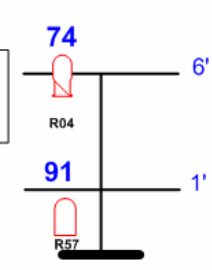

102
ordi

R80
103
p.c.

Symbol	Instrument	Qty
	Leko Etc 19°	2
	Leko Etc 26°	6
	Leko Shakespeare 23/60°	12
	Fresnel 750w	1
	Par 64 (cp81) narrow 1000w	2

Les Deux Mondes travel with their booms.

Booms version 2, NOTES FROM THE JOURNEY HOME	
DEUX MONDES, March 2009 rehearsals	
Booms	
Director: Daniel Meilleur	Page 2 de 2
Designer: Martin Lepage	Scale: 3/16"= 1'
Drawing: Martin Lepage	March 15, 2009